

**OWNER'S MANUAL  
VX10RS - RAIL SAW**

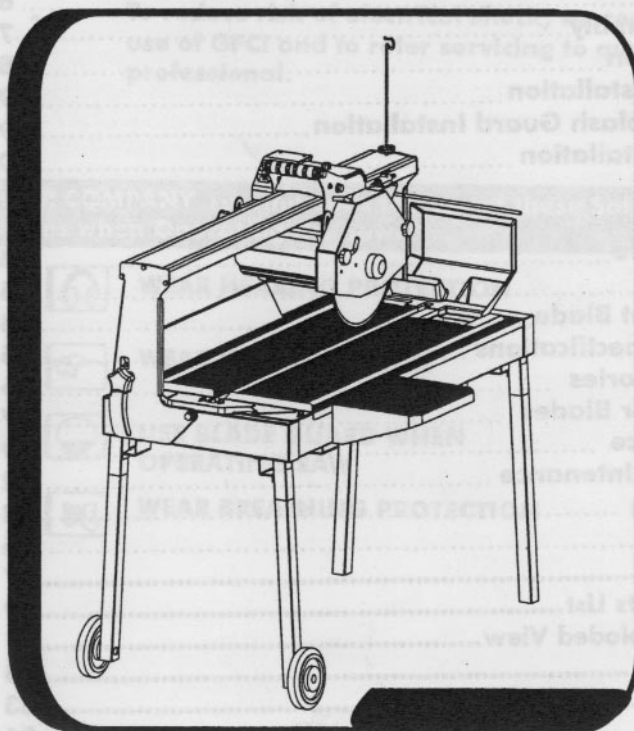

***Before operating the unit, please read this manual thoroughly, and retain it for future reference.***

**PEARL ABRASIVES CO.**

# TABLE OF CONTENTS

## Page

Contents.....	1
Safety Precautions.....	2
General Safety Rules.....	3
Health Warnings.....	3
Unpack, Assembly & Set-up.....	4
Specifications.....	5
Features.....	6
Saw Stand Assembly.....	7
Blade Installation.....	8
Cutting Head Installation.....	9
Side Table 'N Splash Guard Installation.....	9
Water Pump Installation.....	10
The Rip Guide.....	11
Operating the Saw.....	11
The Cutting Table.....	13
Cutting Depth.....	14
Choose the Right Blade.....	14
Electric Motor Specifications.....	15
Optional Accessories.....	16
Do's & Don'ts for Blades.....	17
Saw Maintenance.....	19
Water Pump Maintenance.....	22
Troubleshooting.....	23
Notes.....	26
Warranty.....	27
Replacement Parts List.....	29
VX10RS Saw Exploded View.....	31
Customer Service.....	33
How to Order.....	33
Contact Us.....	34

# SAFETY PRECAUTIONS

Saw blade should be inspected daily for excessive wear, core cracks, and arbor damage. Replace any blade that shows signs of damage.

- To mount blade, clean arbor and outer flanges, tightening nut securely.
- **DO NOT** place any portion of body in line with blade while it is rotating.
- Wet cutting blades must be used with water.
- To reduce risk of electrical shock, we recommend the use of GFCI and to refer servicing to qualified professional.

**OUR COMPANY** recommends the use of these Safety Items when Operating the Saw:



**WEAR HEARING PROTECTION**



**WEAR EYE PROTECTION**



**USE BLADE GUARD WHEN OPERATING SAW**



**WEAR BREATHING PROTECTION**

## General Safety Rules

- Never use the machine improperly or work in an unsafe manner.
- Always wear safety goggles, dust mask, and ear protection while operating the saw (to comply with ANSI-Z87.1).
- Always remain alert when the saw is in use. Failure to pay attention on the operator's part may lead to serious injury.
- Before you start working, familiarize yourself with the work site and its surroundings. Take notice of circumstances which may impede working or traffic, observe soil conditions (good bearing or not), and take measures to ensure safety (i.e. the shielding of roadworks from public traffic).
- Take measures to ensure that the machine is in a safe and trouble-free condition prior to usage. Use the machine only when all protective devices (i.e. guards, noise absorbers, emergency-off devices) are operating in the intended locations.
- A visual check of the machine must be made at least once a shift to ensure that visible damages or faults are recognized. Any changes (including changes in the performance or behavior of the machine) must be reported to the supervisor. If necessary, stop the machine at once and secure it.
- In the case of a malfunction stop the machine immediately and secure it. Fix the problem as soon as possible.
- For starting and stopping the machine follow the operating instruction steps and observe any indicator lights.
- Before switching the machine on make sure that the activated machine will be of no danger to anyone.
- Be sure to connect the plug to a properly grounded receptacle to reduce the risk of electric shock.

## Health Warnings:

Some dust are created by power sanding, sawing, grinding, drilling, and cause other construction activities contains chemicals known to cause cancer, birth defects or other reproductive harm. Some examples of these chemicals are:

- Lead from lead based paints,
- Crystalline silica from bricks and cement and other masonry products,
- Arsenic and chromium from chemically-treated lumber.

Your risk from these exposures varies, depending on how often you do this type of work. To reduce your exposure to these chemicals: work in a well ventilated area, and work with approved safety equipment, such as those dust masks that are specially designed to filter out microscopic particles.

## Unpack, Assembly & Set-Up

### Unpack

Open the container, carefully lift the saw frame handles and place it on a flat, level working area. Be certain that you have the following items before you discard the container:

- Saw
- Slide-In Legs with Wheels
- 10" Saw Blade
- Multiple Rip Guide
- Multiple Wrench
- Water Pump
- Water Level Tube
- Owner's Manual
- Drain Plug
- Bucket

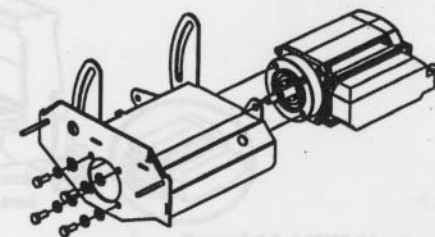

### Assembly & Set-Up

Proceed to the following section to complete assembly of the saw.

1. Remove the carton box cover from the wooden frame.
2. Remove saw from the crate.
3. Loosen the lock knob on top of the cutting head.
4. Install the side extension table, side splash guard and back splash guard.
5. Install the spring holder on top of the sliding rail to hold the power cable and the water hose
6. Fill the tray with water before operating the saw.

## SPECIFICATIONS

The VX10RS professional stone saw is used for cutting floor tiles, paving stones, stairs, large-sized natural stones, and similar materials.

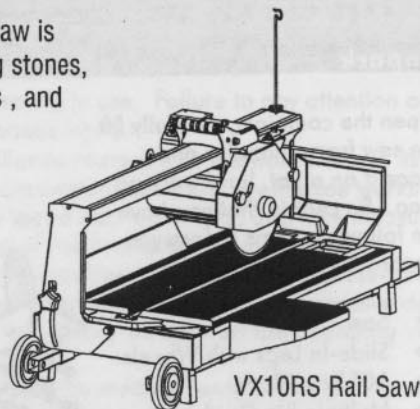

VX10RS Rail Saw

<b>HORSE POWER</b>	1-1/2 HP
<b>VOLTS</b>	115 volts
<b>AMPS</b>	15 A
<b>HERTZ (CYCLES)</b>	60 Hz
<b>MOTOR TYPE</b>	Induction Motor
<b>STAND</b>	Slide-In Legs w/ Wheels
<b>RPM</b>	3450 rpm
<b>MAXIMUM BLADE SIZE</b>	8"-10"
<b>ARBOR SIZE</b>	5/8"
<b>MAXIMUM DEPTH OF CUT</b>	2-5/8"
<b>STRAIGHT CUT LENGTH</b>	37"
<b>DIAGONAL CUT LENGTH</b>	24"
<b>WEIGHT</b>	145 lbs.

## FEATURES

The VX10RS Stone Saw is designed with water flow control in mind. The water pump, inside the tray or as an option it can be used inside a bucket, a water control valve and splash guards ensure proper water flow during operation.

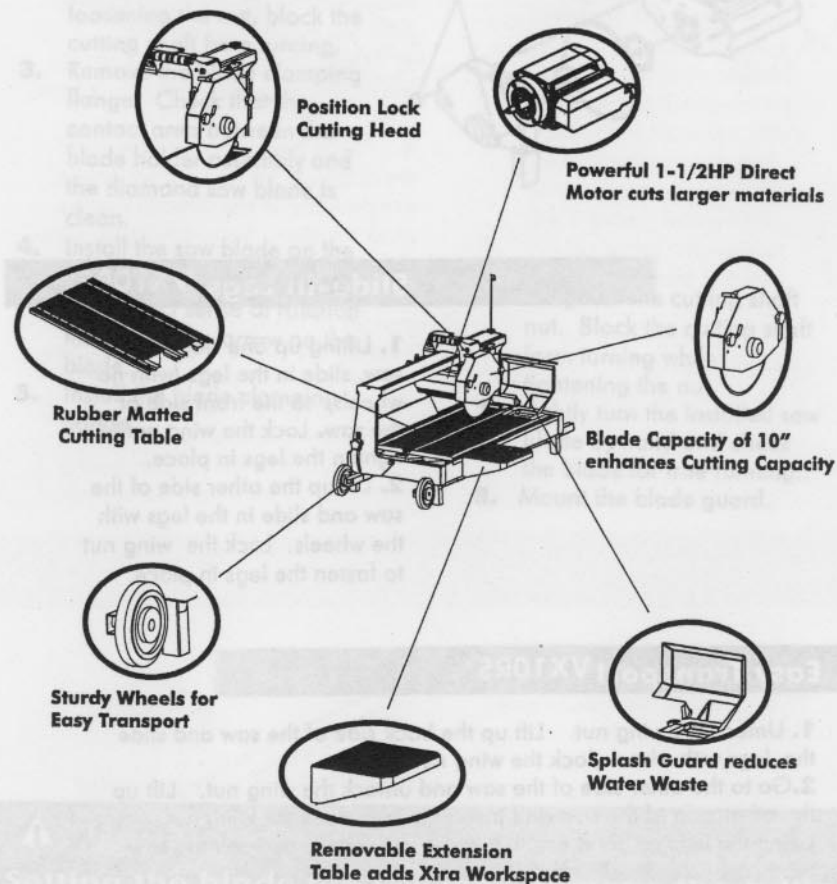



## SAW STAND ASSEMBLY

### Slide-In Legs VX10RS

1. Lifting up one side of the saw, slide in the legs (with no wheels) to the front side of the saw. Lock the wing nut to tighten the legs in place.
2. Lift up the other side of the saw and slide in the legs with the wheels. Lock the wing nut to fasten the legs in place.

### Easy Transport VX10RS

1. Unlock the wing nut. Lift up the back side of the saw and slide the legs with wheels, lock the wing nut.
2. Go to the other side of the saw and unlock the wing nut. Lift up the other side of the saw and insert the legs, lock the wing nut. Using the legs as handles, tilt the saw diagonally and roll the saw on the wheels like a dolly.

## BLADE INSTALLATION

1. Loosen the knurled nuts securing the blade guard and remove the guard.
2. Loosen the cutting shaft nut (left-hand thread); while loosening the nut, block the cutting shaft from turning.
3. Remove the blade clamping flange. Check that the contact area between the blade holder assembly and the diamond saw blade is clean.
4. Install the saw blade on the supporting flange, ensuring the correct sense of rotation marked by the arrow on the blade.
5. Install the blade clamping flange.

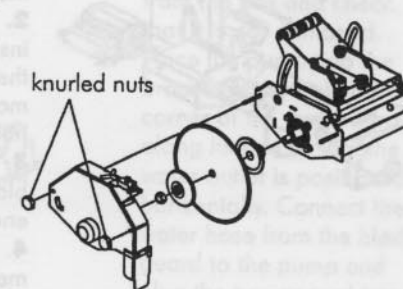

6. Retighten the cutting shaft nut. Block the cutting shaft from turning while tightening the nut.
7. Lightly turn the installed saw blade by hand and check the blade for true running..
8. Mount the blade guard.

### ⚠ WARNING:

**Setting the blade too low may damage the cutting table and if set too high, the blade may grab the material being cut, causing damage and possibly injury.**

## CUTTING HEAD INSTALLATION

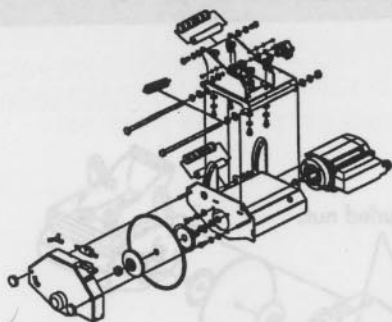

1. Slide the motor into the body of the cutting head mainframe, holding the motor front (outer) ring insert into the mainframe bracket.
2. Holding the cutting head steady, insert 4 bolts onto the front end of the motor through the cutting head mainframe. Lock the bolts tight to hold the motor in position.
3. Insert the inner flange onto the blade shaft against the motor's front end.
4. Place the blade onto the shaft making sure the directional arrows are pointing in the direction of the shaft rotation. Secure in place with the outer flange and blade shaft nut.
5. Insert the main long bolt in the upright of the front plate while holding the cutting head mainframe, lock it tight in position. Insert the second long bolt into the height adjustment slot and lock it tight in position. Place the tension spring into position for height adjustment.

## SIDE TABLE & SPLASH GUARD INSTALLATION

Install the side table and splash guard as shown in the illustration to the side. Fasten the screws respectively to the saw frame.

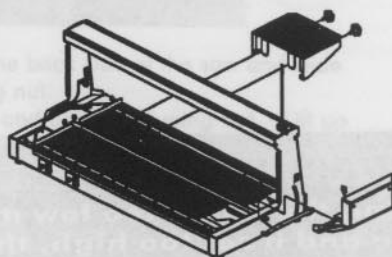

## WATER PUMP INSTALLATION

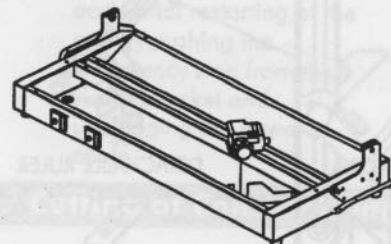

1. Remove the water pump from the box and check that it is not damaged.
2. Place the pump into the bracket at the right front corner of the water tray along its side so that the water outlet is positioned horizontally. Connect the water hose from the blade guard to the pump and plug the power cord into the 3-prong receptacle.
3. Fill the water tray so that the water intake is fully immersed.
4. Be sure to support the pump during installation to prevent pump failure or damage.

### **⚠ WARNING:**

**Disconnect the pump before attempting to handle the pump. Never operate pump without Water in the tray.**

## THE RIP GUIDE

The MasterGuide is a two-piece assembly consisting of a template base and a unique detachable ruler guide. This permits any cutting angle between  $0^\circ$  and  $45^\circ$ , with  $22^\circ$  and  $30^\circ$  clearly designated. The ruler guide also doubles as a measurement tool to accurately measure slabs up to a foot in length. The MasterGuide has a locking mechanism that secures the ruler guide firmly to the template base.

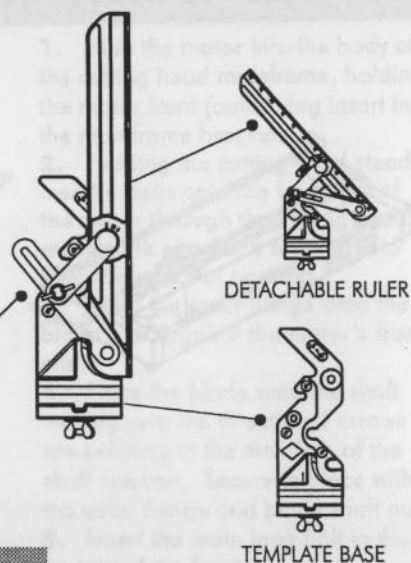

### WARNING:

**Always lock the rip guide prior to transporting the saw.**

## OPERATING THE SAW

1. After you have made yourself familiar with the components of your saw, the machine has been properly set up, the bucket or water tray is filled with water, and the electrical connection is established accordance with the relevant safety regulations, you may now begin with the cutting operation.
2. Before you start operation open the water shut-off valve.
3. During the operation, the user must stand in front side of the saw, holding the handle of the swivel-joint cutting head with his left hand. The workpiece must rest on the work table and should be pressed tightly against the side and limit stops with the right hand.
4. Always turn off the saw before you leave the machine unattended.

## OPERATING THE SAW: continued

5. After the cutting operation is finished, prevent accidental restarting of the saw by pushing the emergency stop from the switch bracket and unplugging the power cable.

### Cutting at Constant Depth

When cutting at constant depth the cutting head must be pulled against the workpiece.

1. Before you start cutting, set the cutting head at the desired fixed cutting depth.
2. Then use the handle to pull the cutting head slowly and uniformly along the guide rail and across the workpiece.
3. Push the cutting head fully back after you finished the cut.

### Plunge Cuts

The handling of larger cutting depths can be simplified using the plunge cutting method.

1. In this case, the cutting head will not be set to a fixed position while performing the cut.
2. As you have not fixed the saw at a defined depth,

the cutting head is freely movable during seesaw operations.

3. Hold the handle of the cutting head with your left hand and move it to and fro across the workpiece while lightly pressing the cutting head downwards in a discontinuous movement.



## THE CUTTING TABLE

### Features:

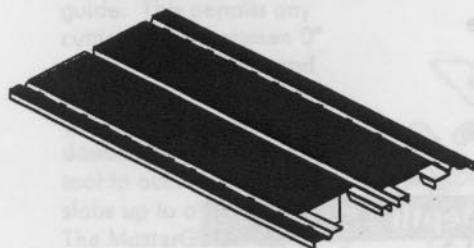

- The easily removable cutting table is covered with an anti-skid rubber coating, which allows the material being cut to sit still on the table while the cutting head is pulled through it.
- Simply line up the material being cut with the appropriate pre-marked lines on the cutting table.

### Steps to make Miter Cuts:

1. The bench saw is equipped with a hinged guide rail that allows the user to make accurate mitre cuts.
2. To pivot the guide rail, lightly loosen the palm grips at both front sides of the saw.
3. Set the rail to the desired angle.
4. Firmly re-tighten the palm grips after setting the guide rail.

## CUTTING DEPTH

The recommended cutting depth is  $\frac{1}{4}$ " below the cutting table surface. The cutting clearance has been fixed from original designed.

### Blade Diameter

### Cutting Depth

8"

1-1/2"

10"

2-5/8"

### ⚠ WARNING:

Setting the blade too low may damage the cutting table and if set too high, the blade may grab the material being cut, causing damage and possibly injury.

## CHOOSING THE RIGHT BLADE

1. The blade shaft speed of this saw is exclusively designed for cutting with diamond saw blades. The saw may only be used for cutting natural and artificial stone materials, do not cut wood or metal!
2. The saw uses diamond saw blades with diameters up to 10". Saw blades with larger diameters must not be installed on the saw.
3. Choose the correct type of saw blade for the material to be cut and the required cutting depth.





## ELECTRIC MOTOR SPECIFICATIONS

### Features:

- Horsepower 1-1/2 H.P.
- Volts 115 V
- Amps 15 Amps
- Motor RPM 3450
- Cycle 60Hz
- Phase 1

### Recommendations:

- It is recommended that a 15 AMP CIRCUIT be used while operating this saw. This will prevent any loss of power or interruption.
- Always plug saw as close as possible to the power source while operating. This will allow you to receive optimum electricity.

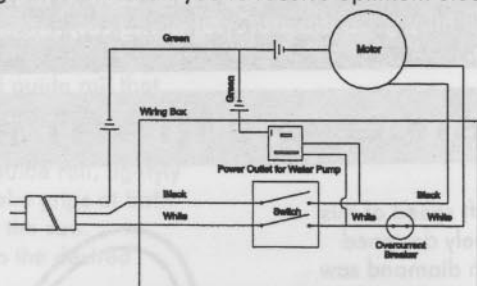

WIRE GAUGE	LENGTH OF CORD 1-1/2 HP - 115 V
No. 12	25'
No. 10	50'
No. 8	75'

### ⚠ WARNING:

To avoid permanent motor damage you must use the correct extension cord. Never use more than one extension cord at a time. Follow the chart for proper size:

## OPTIONAL ACCESSORIES

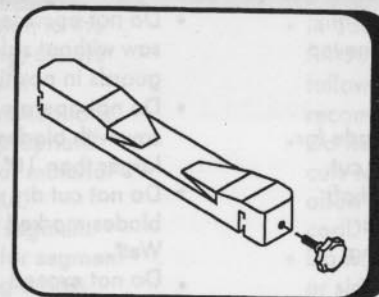

**45° /90° RIP GUIDE**  
Part Number V370068

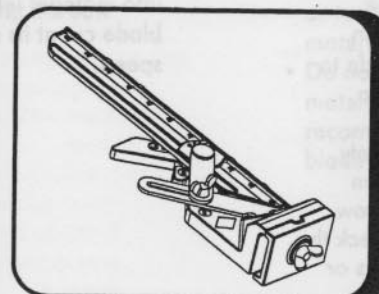

**MASTER GUIDE**  
Part Number V370064

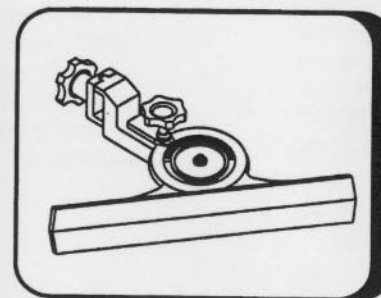

**ANGLE GUIDE**  
Part Number V370060

## Wet Cut Blades

### DO'S

- Inspect blades daily for cracks or uneven wear.
- Always use appropriate blade for material being cut.
- Inspect arbor shaft for uneven wear before mounting blade.
- Always use blades with the correct arbor shaft size.
- Ensure that blade is mounted in the correct direction.
- Secure the blade to the arbor with a wrench.
- Use proper safety equipment when operating the saw.
- Periodically check the blade for cracks or bond fatigue.
- Always have a continuous flow of water on both sides of blade.

### DON'TS

- Do not operate the saw without safety guards in position.
- Do not operate the saw with blades larger than 10".
- Do not cut dry with blades marked "Use Wet".
- Do not exceed manufacturer's recommended maximum RPM.
- Do not force blade into material let blade cut at its own speed.

## Dry Cut Blades

### DO'S

- In addition to the following, always follow wet recommendations.
- Use appropriate blade for material being cut.
- Inspect segment blades for segment cracking or loss.
- Do not use damaged blades.
- Use proper safety equipment when operating the saw.

### DON'TS

- In addition to the following, always follow wet recommendations.
- Do not make long cuts with dry blades--allow them to air cool.
- Do not use the edge or side of blade to cut or grind.
- Do not attempt to cut a radius or curve.
- Do not cut too deep or too fast into the material.
- Do not cut any material not recommended by blade manufacturer.

**⚠ WARNING:**

For your safety, before performing any maintenance on the saw turn off the power switch and unplug the power cord.

**General Rules**

- Always clean the machine before maintenance/repair.
- Before cleaning/maintenance/repair, the machine must be switched off with the main power key.

**Steps to Follow When Cleaning:**

- a. Please do not use aggressive cleaners (i.e. containing solvents). Do not use high-pressure water jets, aggressive detergents or solutions and liquids with a temperature exceeding 86 F! Use a fluff-free cloth only.
- b. Use a cloth which may be lightly moistened only for removing dust and dirt. Hard packed dirt can be removed with a soft brush.
- c. For the sake of safety, no water/cleaning liquid/vapor may penetrate into the electric motor, connectors/plugs, switches, etc.

Therefore cover all apertures, holes in the housing, connectors or plugs, etc. or seal them with adhesive tape!

- d. Use a soft, low-pressure water jet and a brush to rinse dirt and incrustations away. Be particularly careful when near hazardous parts of the machine (e.g. switch, motor). Clean the motor and switches only by wiping with a moist cloth.

- e. Do not "rinse" the bearings of the drive elements to prevent them from running dry. The ball bearings of the machine are permanently lubricated.

- f. After cleaning, remove all covers and adhesive tape! All screws/nuts which you may have loosened must be tightened again!

- g. After wet cleaning, try the machine on a power outlet which is equipped with a power breaker (i.e. fault current circuit breaker). If the fault current circuit breaker cuts the power supply, the machine must be inspected by an authorized dealer prior to use!

**Cleaning****After every use of the machine:**

- Remove dirty water from container.
- Remove dirt and mud from the bottom of the container.
- Rinse the immersion pump with fresh water to prevent water pump clogging from residual dirt.

**After wet cleaning and before using the machine again:**

- Connect the machine to an electric power outlet equipped with a "GFCI" safety power breaker. If the safety power breaker cuts off the electrical power supply, do not try to operate the machine but have it checked by an authorized dealer first.



## Before & After A Prolonged Time

### Before not using the machine for a prolonged period of time:

- Clean and lubricate all movable parts. DO NOT GREASE THE GUIDE RAILS.

### After not using the machine for a prolonged period of time:

- Check that the legs are safely fixed.
- Check that all screw joints and nuts are fixed.
- Check that the roller table is in its guides and that it easily moves to and fro.
- With the saw blade removed, switch on the motor for an instant and switch it off again. If the motor does not run, have the machine inspected by a qualified electrician.

### After not using the machine for a prolonged period of time:

- Check that the immersion pump works properly. Turn on the cooling water tap and switch the machine on. If the pump does not give any water or only a little, switch the machine off at once. Clean the pump, or replace if necessary.

## Temperature Changes

### Ambient Temperature Below 37° F (Winter)

- To prevent the water in the pump and cooling system from freezing, remove the water after using the machine or when there will be a long break. Make sure that the cooling system is entirely drained so that there is no water left inside the pump, the bearing house and water hose!

## WATER PUMP MAINTENANCE

When the machine has not been used for a long period of time, hard packed dirt may begin to build up inside the pump and block the pump wheel. If the machine is activated with the immersion pump blocked, the electric motor of the pump will be damaged within a few minutes! Please follow the steps listed below to clean the pump before operating the saw.

1. Unscrew the pump filter.
2. Remove the immersion pump from the water container.
3. Clean the immersion pump.

4. Loosen the fixing screws of the pump lid.
5. Take the lid off the pump (be careful not to damage the gasket located inside with a sharp object!)
6. Clean the pump lid.
7. Remove all dirt and incrustations from the pump wheel.
8. Check whether the pump wheel can be easily turned.
9. Then reassemble the immersion pump correctly and check whether it works properly.

## TROUBLESHOOTING

PROBLEM	POSSIBLE CAUSE	SOLUTION
Machine does not run when switched on	- Power cord not properly fixed/plugged in	- Check that the machine is properly connected to the power supply
	- Power cord defective	- Have the power cord checked, replace if necessary
	- Main power switch defective	- Have the main power switch checked and replace if necessary by a qualified electrician
	- Loose electrical connection inside the electric system	- Have the whole electric system of the machine checked by a qualified electrician
Motor stops (power cut out)	- Motor defective	- Have the motor checked and replaced if necessary by a qualified technician
	- Too much pressure exerted while cutting	- Exert less pressure when cutting
	- Incorrect specification for saw blade	- Use a saw blade which corresponds to the material being cut
Poor machine performance little power	- Saw has a defective electric system	- Have the electric system of the saw checked by a qualified technician
	- Power cord/extension cable too long or cable still wound up inside cable drum	- Use a power cord/extension cable of the rated length, use a cable drum with cable fully extended
	- Power network is insufficient	- Observe the electrical ratings of the machine and connect it only to a power network which complies with these ratings

## TROUBLESHOOTING

PROBLEM	POSSIBLE CAUSE	SOLUTION
	- Drive motor no longer runs at rated speed (r.p.m.)	- Have the motor checked by a qualified electrician and have it replaced if necessary
Insufficient flow of cooling water or no cooling water at all	- The pump draws air	- Fill the container with water
	- Filter clogged	- Clean the filter of the pump
	- Pump wheel of the immersion pump blocked by dirt	- Disassemble the immersion pump and clean
Irregular run of the saw blade	- Poor tension in the blade material	- Return the saw blade to the manufacturer
Saw blade wobbles when running	- Saw blade is damaged or bent	- Have the saw blade aligned/flattened
		- Clean the receiving flange
		- Solder the diamond segments of the old blade onto another saw blade or use a new blade
	- Flange of the saw blade is damaged	- Replace the saw blade flange
	- Shaft of the motor is bent	- Replace the electric Motor
Diamond segment becomes loose	- Overheating of the saw blade; cooling water not sufficient	- Have the diamond segment soldered on the blade again; ensure optimum flow of cooling water
Excessive wear	- Wrong type of saw blade	- Use harder saw blades
	- Shaft of motor causes wobbling	- Have bearings of the motor or the motor replaced
	- Overheating	- Ensure optimum flow of cooling water

## TROUBLESHOOTING

PROBLEM	POSSIBLE CAUSE	SOLUTION
Cracks in or near the diamond segment	<ul style="list-style-type: none"> <li>- Saw blade too hard</li> <li>- Fixed flange is worn out</li> </ul>	<ul style="list-style-type: none"> <li>- Use a softer blade</li> <li>- Have the fixed flange replace</li> </ul>
	<ul style="list-style-type: none"> <li>- Motor shaft bearing</li> </ul>	<ul style="list-style-type: none"> <li>- Replace the bearing Of the motor shaft</li> </ul>
Saw blade is blunt	<ul style="list-style-type: none"> <li>- Saw blade type is unsuitable for the material being cut</li> <li>- Saw blade type is unsuitable for the machine performance</li> <li>- Saw blade too hard</li> </ul>	<ul style="list-style-type: none"> <li>- Use appropriate type of saw blade</li> </ul>
	<ul style="list-style-type: none"> <li>- Diamond segments are blunt</li> </ul>	<ul style="list-style-type: none"> <li>- Sharpen the diamond saw blade</li> </ul>
Appearance of cut is not optimal	<ul style="list-style-type: none"> <li>- Poor tension in the blade material</li> </ul>	<ul style="list-style-type: none"> <li>- Return the saw blade to the manufacturer</li> </ul>
	<ul style="list-style-type: none"> <li>- Too much load placed on the saw blade</li> <li>- Diamond segments are blunt</li> </ul>	<ul style="list-style-type: none"> <li>- Use a suitable saw blade</li> <li>- Sharpen the saw blade</li> </ul>
The center hole in the saw blade has become wider due to wear	<ul style="list-style-type: none"> <li>- The saw blade has slipped on the motor shaft when running</li> </ul>	<ul style="list-style-type: none"> <li>- The arbor of the saw blade must be fitted with an appropriate adaptor ring</li> <li>- Check the receiving flange and have it replaced if necessary</li> </ul>
Saw blade shows blooming colors	<ul style="list-style-type: none"> <li>- Saw blade overheating due to a lack of cooling water</li> </ul>	<ul style="list-style-type: none"> <li>- Ensure an optimum flow of cooling water</li> </ul>
	<ul style="list-style-type: none"> <li>- Lateral friction when cutting</li> </ul>	<ul style="list-style-type: none"> <li>- The material feed is too high; proceed more slowly</li> </ul>
Grinding marks on the saw blade	<ul style="list-style-type: none"> <li>- Material is not being fed parallel to the saw blade</li> <li>- Poor tension in the blade material</li> </ul>	<ul style="list-style-type: none"> <li>- Ensure that the direction of feed is absolutely parallel to the saw blade</li> <li>- Adjust the roller table/have it adjusted</li> </ul>
	<ul style="list-style-type: none"> <li>- Too much load on the saw blade</li> </ul>	<ul style="list-style-type: none"> <li>- Have the saw blade tensioned</li> <li>- The material feed is too high, proceed more slowly</li> </ul>

## NOTES



## LIMITED WARRANTY

### 1. SAW:

For a period of one (1) year from the original date of purchase, if the product is determined to be defective, we will repair or replace the product, at its option, at no charge to the customer, or pay the associated repair costs to an authorized service facility. All replacement parts, new or rebuilt, supplied at our option for repairs will be warranted for the remainder of the original warranty period of one (1) year. All defective products or components replaced under this limited warranty will become our property. This limited warranty excludes all components not manufactured by OUR COMPANY, which are listed below with their corresponding independent warranty periods. Such components are warranted by their respective manufacturer, whose warranty will be the governing warranty for that particular product.

Excluded Components	Manufacturer's Warranty
Electric Motors	1 year
Water Pumps	Varies by Model See Accompanied Warranty for details.

### 2. BLADE BOUGHT FROM OUR COMPANY:

If the bond between the steel core and segment or rim fails during the normal useful life of the blade, we will replace the blade at no cost to the customer.

This warranty does not cover cosmetic damages or damages due to (1) misuse, abuse, negligence, accident, or modifications of the product or any of its components; (2) improper operation or failure to provide reasonable maintenance; or (3) attempted repair by any party other than a authorized service facility. All products are subject to wear and tear under normal use. As such, the customer is responsible for all costs associated with the maintenance of said product, including the purchase of replacement components thereof.

## LIMITED WARRANTY

To obtain warranty service, you must take the product, or deliver the product freight prepaid, in either its original packaging or packaging affording an equal degree of protection, to service facility authorized by us, along with proof of purchase in the form of a bill of sale, within the warranty period specified above. Warranty may be void if additional damages are incurred during transportation due to inadequate packaging.

WE shall not be responsible for or obligated to pay for freight or other transportation related costs or expenses in connection with any defective products or components that are either returned to OUR facility or any authorized repair station and/or any replacement products or components that are shipped from OUR pursuant to this Warranty.

OUR COMPANY SHALL NOT BE LIABLE FOR ANY INCIDENTAL OR CONSEQUENTIAL DAMAGES FOR BREACH OF ANY EXPRESS OR IMPLIED WARRANTY, OR NEGLIGENCE. SUCH DAMAGES INCLUDE, BUT ARE NOT LIMITED TO, LOSS OF PROFITS, LOSS OF REVENUE, LOSS OF USE OF THE PRODUCT, AND DOWN TIME. OUR LIABILITY SHALL NOT EXCEED THE REPLACEMENT COST OF ANY DEFECTIVE PRODUCT OR COMPONENT THEREOF. THIS LIMITED WARRANTY IS IN LIEU OF ALL OTHER WARRANTIES, WHETHER EXPRESSED OR IMPLIED.

### Exclusions From Warranty

WE cannot assume responsibility for claims arising from abuse of the OUR product:

- Due to abuse by the Purchaser in their processing.
- Due to improper installation practices or procedures.
- Due to abuse or improper usage by the end-user.
- Due to contaminants, including, but not limited to, exposure to salt or fresh water, chemicals and any other form of contamination from a source outside of OUR control.

## REPLACEMENT PARTS LISTS - VX10RS

PART NAME	PART No.
1 Guide Rail	V370001
2 Ruler Guide Bolt (set of 4)/M6X16	V370002
3 Supporting Post Lock Bolt/ M5X20	V370003
4 Ruler Guide	V370004
5 Angle Adjustment Lock Knob	V370005
6 Front Rubber Cutting Table	V370006
7 Center Lock Nut/ M10	V370007
8 Front Rubber Mat Cutting Table	V370008
9 Drain Plug	V370009
10 Main Metal Frame	V370010
11 Water Pump	V370011
12 Cable & Hose Spring Hanger	V370012
13 Extension Table Lock Knob	V370013
14 Side Extension Table	V370014
15 Side Splash Guard	V370015
16 Rear Rubber Cutting Table	V370016
17 Splash Guard Wing Nut/M6	V370017
18 Back Water Splash Guard	V370018
19 Cable & Hose Position Bracket	V370019
20 Angle Adjustment Bolt/M6X20	V370020
21 Rear Support Post Plate	V370021
22 Angle Adjustment Knob	V370022
23 Water Flow "Y" Adapter	V370023
24 Water Control Valve	V370024
25 Blade Guard Lock Knob	V370025
26 Blade Guard	V370026
27 Water Splash Guard	V370027
28 Blade Lock Nut/M12	V370028
29 Outer Flange	V370029
30 Motor Mounting Lock Bolt/M8X16	V370030
31 Motor Cutting Angle Screw/ Hex. Screw 250 M10	V370031
32 Handle Rubber Sleeve	V370032
33 Motor Cutting Angle Adjustment Screw/Hex.Screw 235 M10	V370033
34 Tension Spring	V370035
35 Cutting Head Carriage Bracket	V370036
36 Handle Bar	V370037

## REPLACEMENT PARTS LISTS - VX10RS

PART NAME	PART No.
37 Handle Rubber Sleeve	V370038
38 Cutting Head Position Bracket	V370039
39 Motor Position Lock Knob	V370040
40 Circuit Breaker	V370041
41 Toggle Switch	V370042
42 Switch Housing Control Panel	V370043
43 Switch Housing Complete Set	V370044
44 Cable Protective Rubber Sleeve	V370045
45 Adjustment Guide Wheels (1)	V370046
46 Cutting Height Adjustment Lock Knob	V370047
47 Lock Nut/ M10	V370048
48 Power Cable/ 14AWG	V370049
49 1-1/2 HP Motor	V370050
50 Motor Mounting Bracket	V370051
51 Cutting Table Head Travel Bumper	V370052
52 Inner Flange	V370053
53 Diamond Blade	V370054
54 Angle Adjustment Screw/ Nut M6	V370055
55 Adjustment Guide Wheels (set of 2)	V370056
56 Rolling Wheels (3)	V370057
57 Multiple Wrench	V370058
58 Masterguide Template Base	V370059
59 180° Adjustment Angle Guard	V370060
60 Water Pump Adapter	V370061
61 Slide-In Legs with Wheels (set of 2)	V370062
62 Detachable Ruler Guide (Optional) need Template Base	V370063
63 MasterGuide Multiangle Guide	V370064
64 Slide-In Legs (set of 2)	V370065
65 Rubber Wheel	V370066
66 Bucket	V370067



Note: If there is any part that is needed and has not been included in this parts list, please contact our customer service

# EXPLODED VIEW

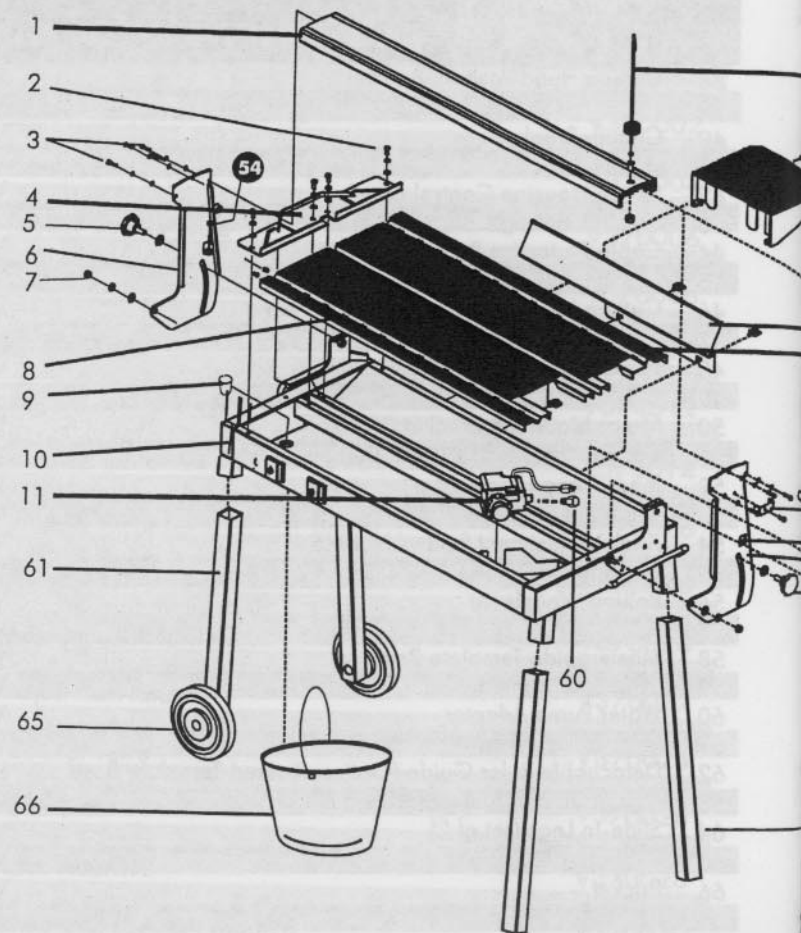

180° Adjustable Guide (Optional)

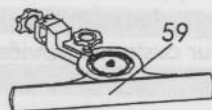

Master Guide 45°/90° (Optional)

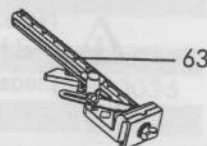

Detail

Ruler Guide (Optional)



(Requires Template Base)

Accessories (Included)

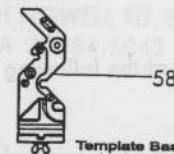

Template Base

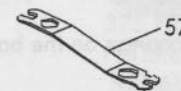

Multiple Wrench



## CUSTOMER SERVICE

### AFTER SALE SERVICE

All customer service (technical questions, re-order of parts, etc.) will be provided by our company.

All spare parts for after sales service will be stocked and shipped from our warehouse.

If requested, we may arrange for our sales representatives to hold a training class for product knowledge at dealer's location.

### DISCLAIMER:

#### PEARL ABRASIVE CO.

Reserves the right to make changes or improvements on its products without incurring an additional obligation including any obligation to make corresponding changes or improvements to products previously manufactured or sold. PEARL reserves the right to discontinue products at any time without notice.

## HOW TO ORDER:

### Information Needed For Ordering:

- Serial Number of the Saw
- Model Number of the Saw
- When it was purchased and where
- Part Description

If you need to order replacement parts, please contact our customer service department. You can reach us at the contact information listed below.

#### Customer Service:

Phone: (800) 969-5561

Fax: (562) 928-3857

Web: [pearlabrasives.com](http://pearlabrasives.com)

### RETURN POLICY:

Return goods for credit or exchange on the basis of the following terms:

- 1) They must be current products
- 2) Items returned for replacement or refund should be in original cartons and must be accompanied by a packing slip with the following information:  
Returned Goods Authorization (RGA) number obtainable from Customer Service Department \* List of items returned \* Reason (s) for return (s) \* Copy of original invoice (s)
- 3) Freight charges must be assumed by sender
- 4) Returning goods are subject to a 15% handling charge to cover our cost of repacking and restocking. All Prices are subject to change without notice.

## CONTACT US

We pride ourselves on our customer service. If you have any questions regarding our products, whether it may be product inquiry or troubleshooting, please don't hesitate to contact us at our corporate office. We will do our best to answer your questions. In some cases we may even refer you to a local sales representative that can better service you. You can email or call us at the contact information listed below:



### CUSTOMER SERVICE:

6210 S. GARFIELD AVENUE  
COMMERCE, CA 90040-0031

Phone: (800) 969-5561

Fax: (562) 928-3857

Web: [pearlabrasives.com](http://pearlabrasives.com)

#### ILLINOIS, USA

813 CENTRAL AVE.  
WOOD DALE, IL 60191-1219

#### TEXAS, USA

803 AVE. H EAST #303  
ARLINGTON, TX 76011-7727

#### GEORGIA, USA

4761 HUGH HOWELL RD, STE. N  
TUCKER, GA 30084-5042

#### NEW JERSEY, USA

745 GOTHAM PARKWAY  
CARLSTADT, NJ 07072-2413

#### N. CALIFORNIA, USA

1777 ROGERS AVE.  
SAN JOSE, CA 95112-1109

#### ONTARIO, CANADA

375 PIDO ROAD  
PETERBOROUGH, ONTARIO  
K9J-6X7

All illustrations displayed in this manual are property of Pearl Abrasives Co. and shall not be duplicated or reproduced without the express written consent of Pearl Abrasives Co.